

Assembling SKU 537-5252.49 Boom Kit

Parts provided in kit:

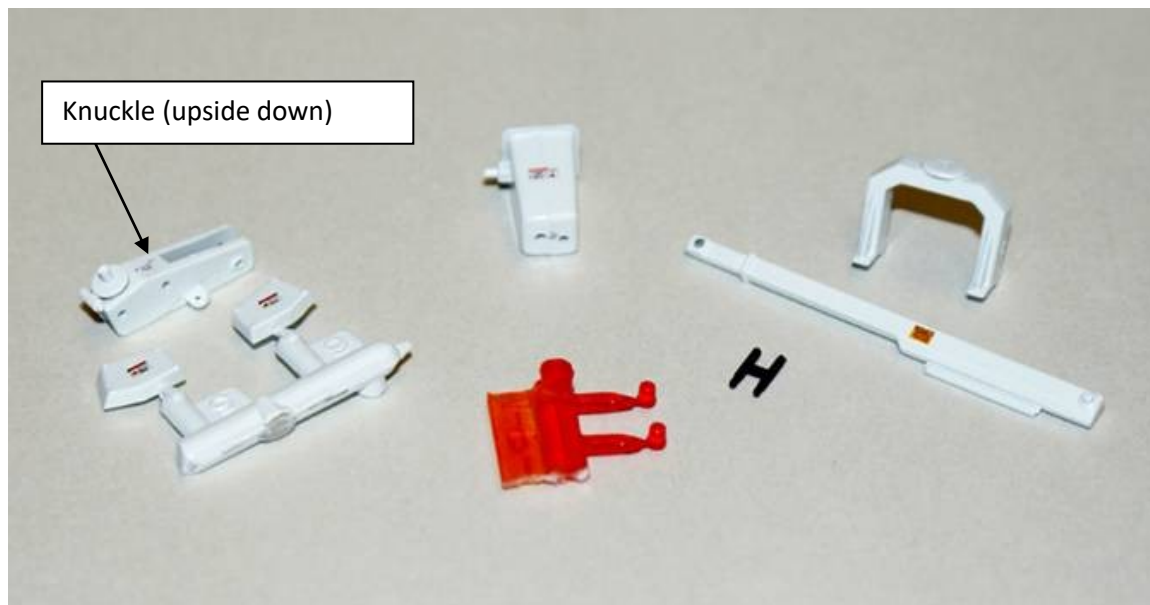

When assembled, it should look like this:



There are locating pins for all of the parts—they are intended to assist in positioning the parts, but we recommend using some adhesive once you have posed the parts in the desired positions.

Start by carefully spreading the fork of the knuckle, and insert the boom in the orientation shown—do not glue at this time. Next glue the motor and hydraulic housings to the sides of the knuckle, using the pins as a guide. Glue the beacons into place, and position the bucket at the end of the arm.

You can remove the pins at the bottom of the support bridge or alternatively drill a pair of holes for them into the mating part, and glue the bridge in place—orientation doesn't matter since the bridge is symmetrical. When the glue is cured, mount the arm sub-assembly into place, orient the parts as desired, and place a small drop of glue where the parts join to secure everything.

While the friction fit of the various pins will temporarily support the joints, repeated repositioning will eventually break the pins. The pins are not intended to be bearings. Small drops of gap filling CA adhesive are easily added once positioned, and this provides suitable reinforcement for handling.

If a longer reach boom is desired for your scene, please refer to the How To article on the 1-87 Vehicle Club's Website:

http://www.1-87vehicles.org/how_to/rps_service-utility_accessories.php